

STATE	STATE PROJECT REFERENCE NO.	SHEET NO.	TOTAL SHEETS
N.C.	2017CPT.01.04.20211.1 ETC.	1	
STATE PROJ. NO.	F.A. PROJ. NO.	DESCRIPTION	

STATE OF NORTH CAROLINA
DIVISION OF HIGHWAYS

CHOWAN COUNTY

LOCATION: MAP #1 SR 1207 (FROM SR 1200 TO SR 1222) MAP #2 SR 1230 (FROM NC 32 TO SR 1226)
MAP #3 SR 1226 (FROM SR 1222 TO SR 1228)

TYPE OF WORK: RESURFACING

CONTRACT NO.: DA00303 WBS ELEMENT : 2017CPT.01.04.20211.1 ETC.

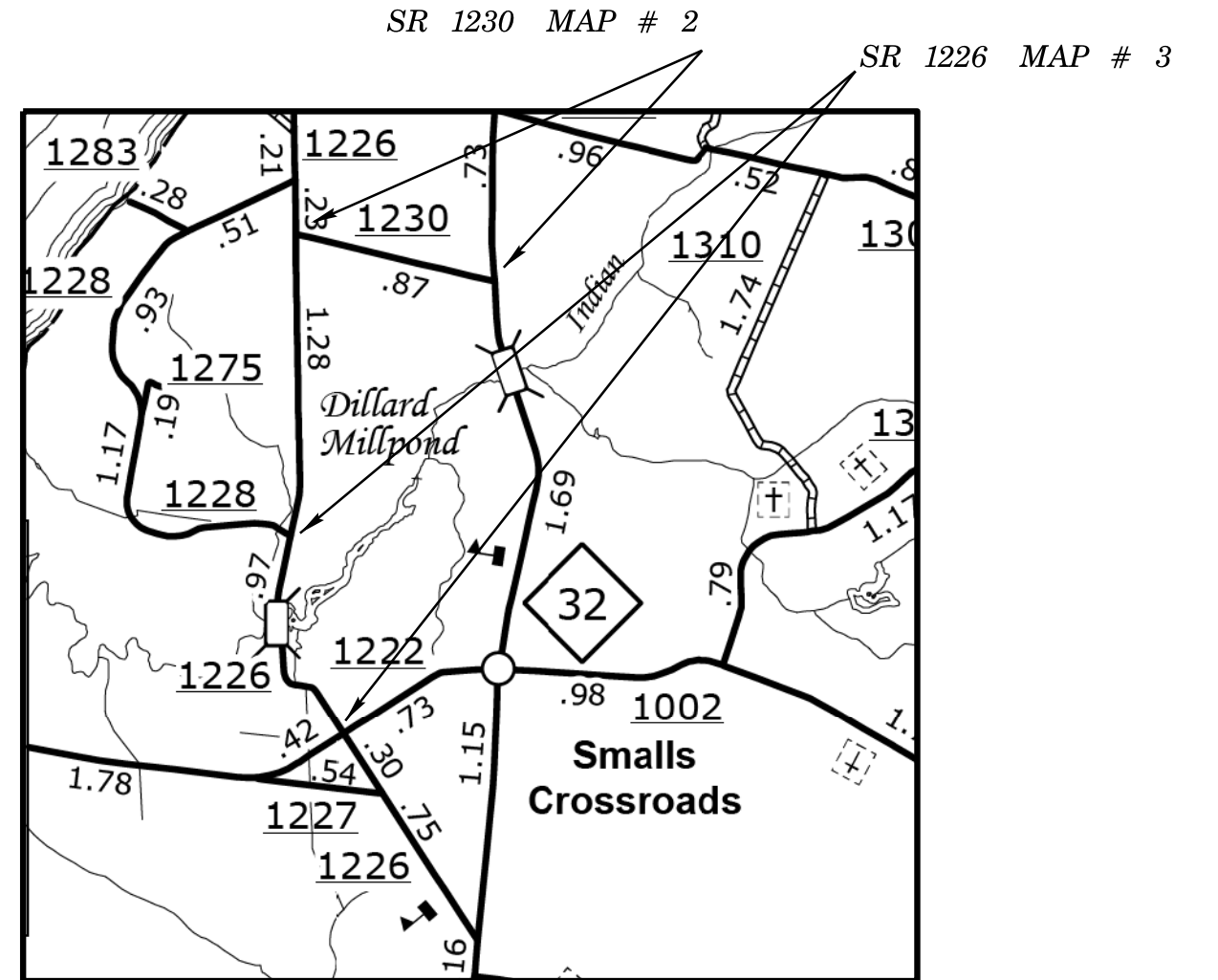
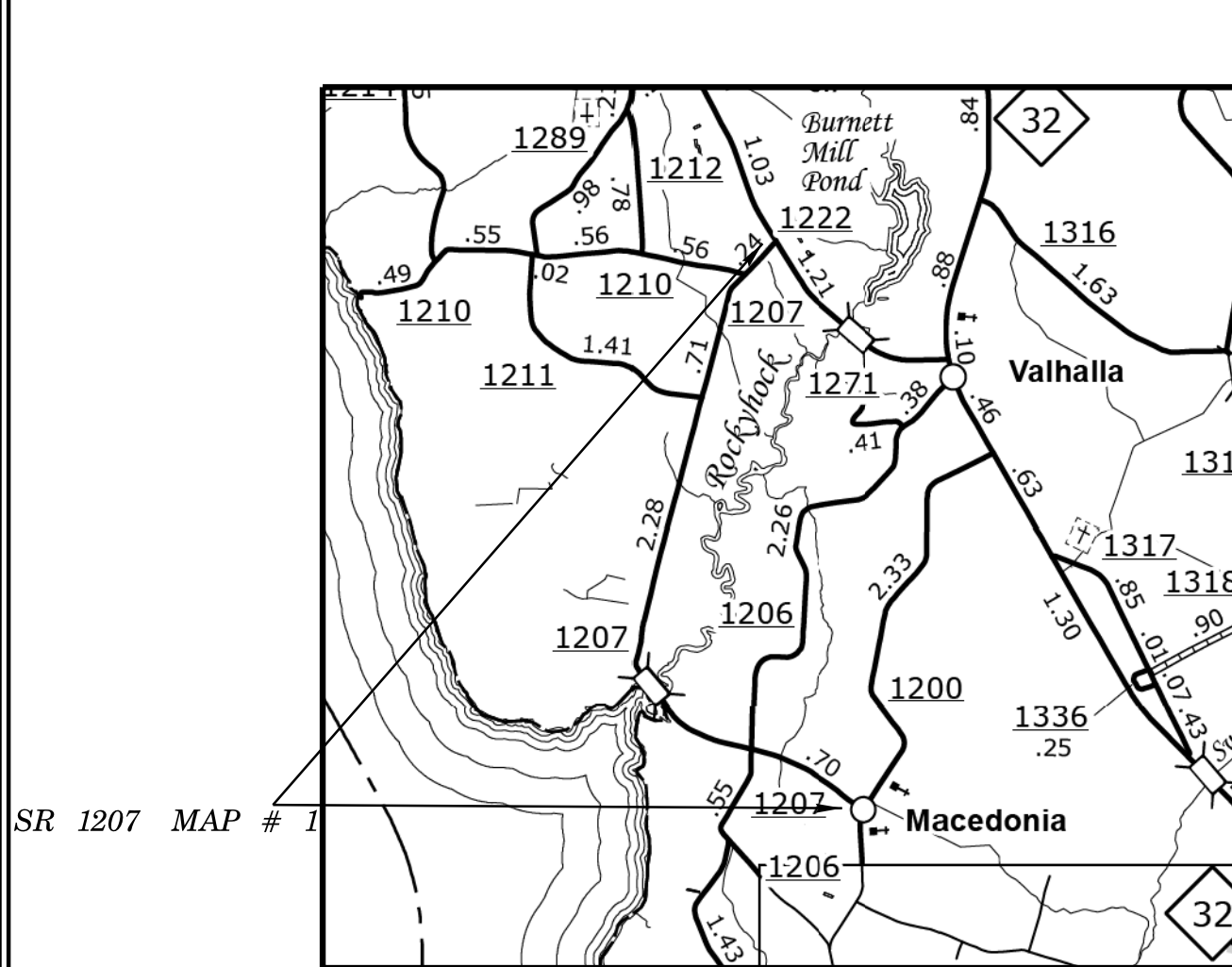

NOT TO SCALE

PROJECT LENGTH

LENGTH OF ROADWAY PROJECT MAP# 1 = 3.20 MILES
LENGTH OF ROADWAY PROJECT MAP# 2 = 0.87 MILES
LENGTH OF ROADWAY PROJECT MAP# 3 = 0.97 MILES

Prepared in the Office of:
DIVISION OF HIGHWAYS

2012 STANDARD SPECIFICATIONS

LETTING DATE:

W.B. HOBBS, P.E.
DIVISION PROJECT MANAGER

C.E. SLACHTA
DIVISION PROPOSALS ENGINEER

DIVISION OF HIGHWAYS
STATE OF NORTH CAROLINA

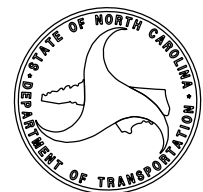

NOTES:

1. ALL PAVED S.R. ROADS TO BE RESURFACED TO THE ENDS OF THE RADII OR AS DIRECTED BY THE ENGINEER
2. EDGES, PAVEMENT WIDENING, INTERSECTIONS, AND BRIDGE FLARES ARE INCLUDED IN THE TABLE OF QUANTITIES
3. SHOULDERS AND DITCHES ARE TO BE CONSTRUCTED BY OTHERS
4. PAVEMENT MARKING TO BE APPLIED BY OTHER
5. INCIDENTAL MILLING TO USED FOR BRIDGE APPROACHES

PROJECT REFERENCE NO.	SHEET NO.
2017CPT.01.05.20211.1 ETC.	3

PAVEMENT SCHEDULE	
C1	PROP. APPROX. 1.5" ASPHALT CONCRETE SURFACE COURSE TYPE SF9.5A, AT AN AVERAGE RATE OF 165 LBS. PER SQ.YD.
U	EXISTING PAVEMENT.

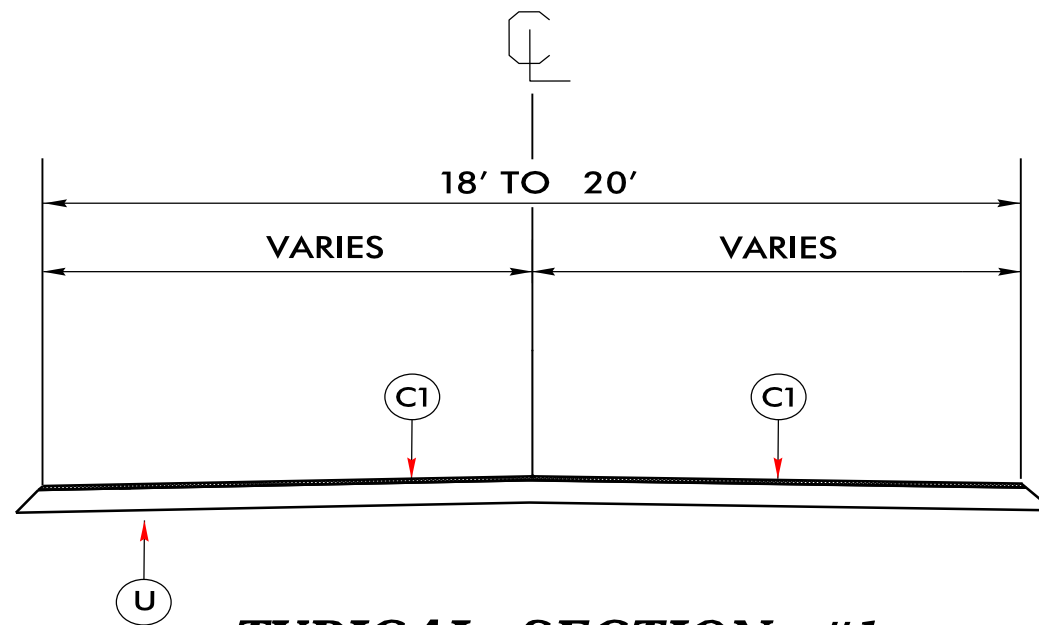

TYPICAL SECTION #1

USE WITH MAP 1 - 8

PROJECT NO.	SHEET NO.	TOTAL NO.
2017CPT.01.04.20211.1, ETC.	4	

SUMMARY OF QUANTITIES

PROJECT	COUNTY	MAP	ROUTE	DESCRIPTION	TYP	LANES	LANE TYPE	FINAL SURFACE TESTING REQUIRED	WARM MIX ASPHALT REQUIRED	LENGTH	WIDTH	MOBILIZATION	INCIDENTAL MILLING	SURFACE COURSE, SF9.5A	ASPHALT BINDER FOR PLANT MIX	TEMPORARY TRAFFIC CONTROL
NO		NO			NO					MI	FT	LUMP SUM	SY	TONS	TONS	LUMP SUM
2017CPT.01.04.20211.1	Chowan	1	SR 1207	FROM SR 1200 TO SR 1222	1	2	2WU	NO	NO	3.2	18	1	450	3,088	207	1
2017CPT.01.04.20211.1	Chowan	2	SR 1230	FROM NC 32 TO SR 1226	1	2	2WU	NO	NO	0.87	20	*		932	62	*
2017CPT.01.04.20211.1	Chowan	3	SR 1226	FROM SR 1222 TO SR 1228	1	2	2WU	NO	NO	0.97	20	*	450	1,039	70	*
2017CPT.01.04.20581.1	Martin	4	SR 1128	FROM SR 1127 TO SR 1129	1	2	2WU	NO	NO	1.7	20	*		1,821	122	*
2017CPT.01.04.20581.1	Martin	5	SR 1305	FROM NC 903 TO SR 1300	1	2	2WU	NO	NO	3.12	20	*		3,343	224	*
2017CPT.01.04.20581.1	Martin	6	SR 1527	FROM SR 1516 TO SR 1530	1	2	2WU	NO	NO	2.3	20	*		2,464	165	*
2017CPT.01.04.20581.1	Martin	7	SR 1138	FROM SR 1404 TO NCL	1	2	2WU	NO	NO	1.38	20	*		1,479	99	*
2017CPT.01.04.20581.1	Martin	8	SR 1138	FROM SR 1113 TO SR 1142	1	2	2WU	NO	NO	1.72	20	*		1,843	123	*
GRAND TOTAL										15.26		1	900	16,009	1,072	1

- NOTES:
- 1) DETAIL DOES NOT APPLY TO OGAFc AND ULTRA-THIN BONDED WEARING COURSE.
 - 2) BACKFILL SHOULDER WITH APPROVED MATERIAL.
 - 3) THE SHOULDER WEDGE DEVICE MAY BE DISENGAGED AT PAVED DRIVEWAYS AND SIDE STREETS.

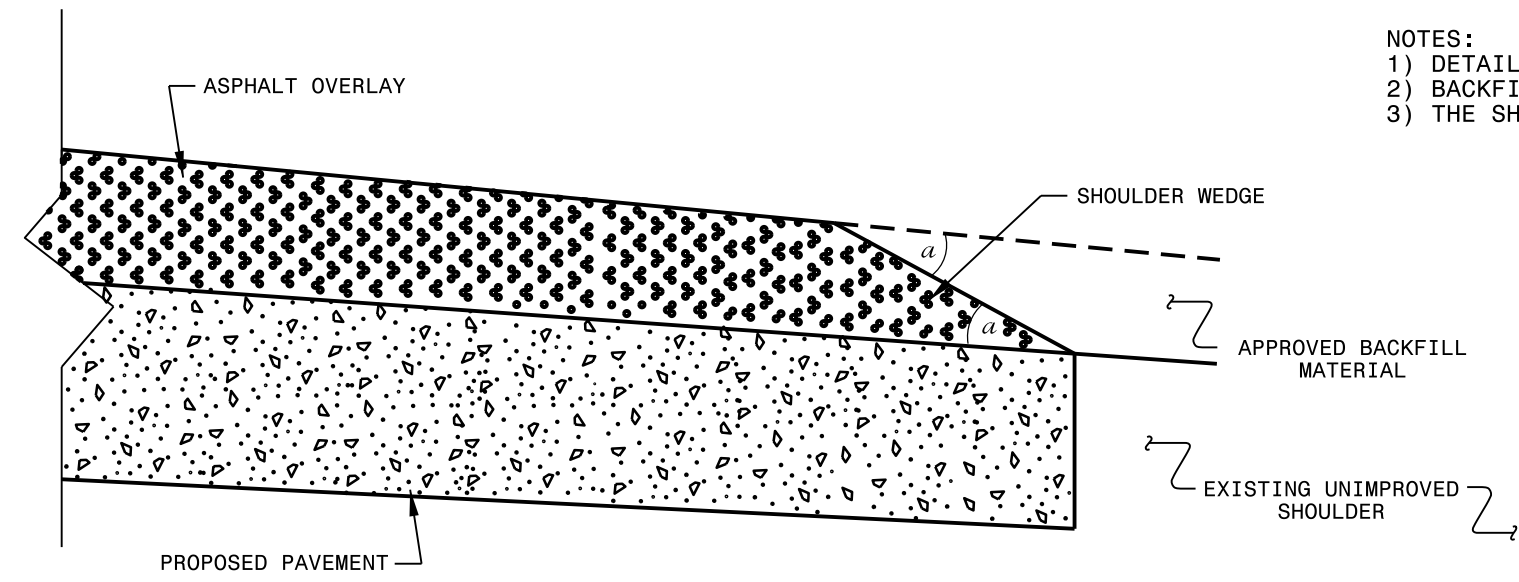

SHOULDER WEDGE DETAIL
 (Resurfacing Projects w/ Widening or
 with Existing Paved Shoulder having no dropoffs)

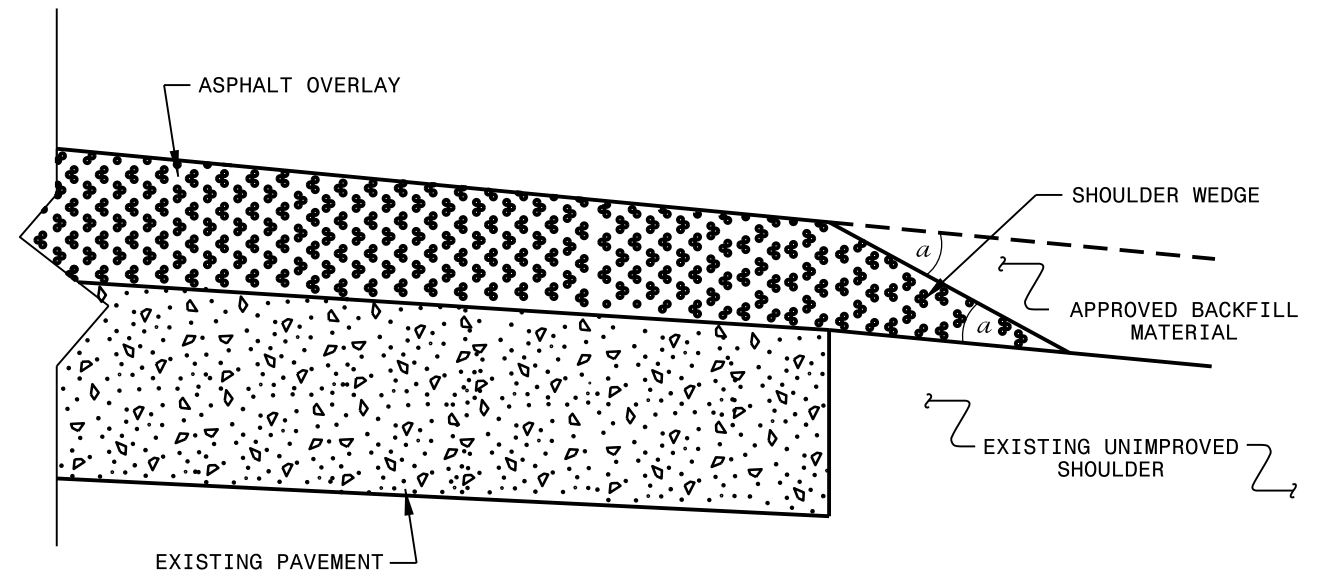

SHOULDER WEDGE DETAIL
 (Resurfacing Projects w/ NO Widening)

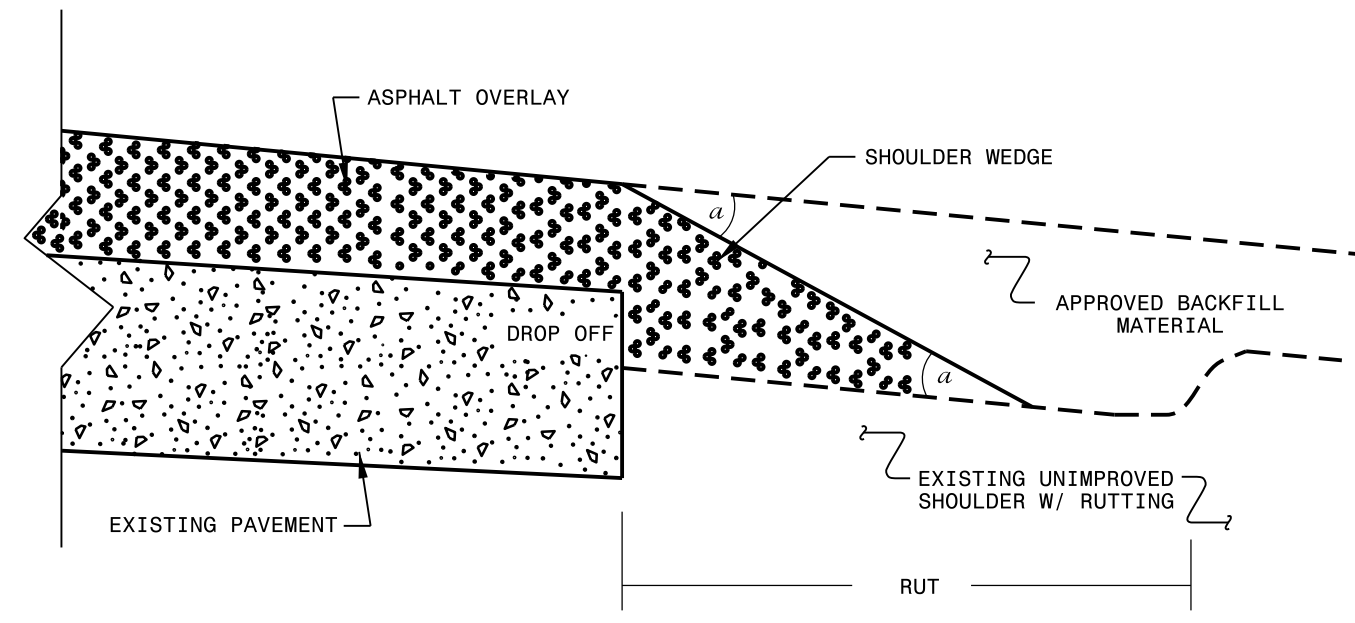

SHOULDER WEDGE DETAIL
 (Resurfacing Adjacent to
 Rutted Shoulder)

- SHOULDER WEDGE ANGLE = 30°

CONTRACT STANDARDS
 AND DEVELOPMENT UNIT
 Office 919-707-6950 FAX 919-250-4119

**SHOULDER WEDGE
 DETAILS**

ORIGINAL BY: T.SPELL DATE: 7-19-11
 MODIFIED BY: DATE: 10/16/12
 CHECKED BY: DATE:
 FILE SPEC.: susr/details/stand/shoulderwedgedetail.dgn

SYSTEMS DESIGN
 USER NAME

SIGNING FOR RESURFACING PROJECTS

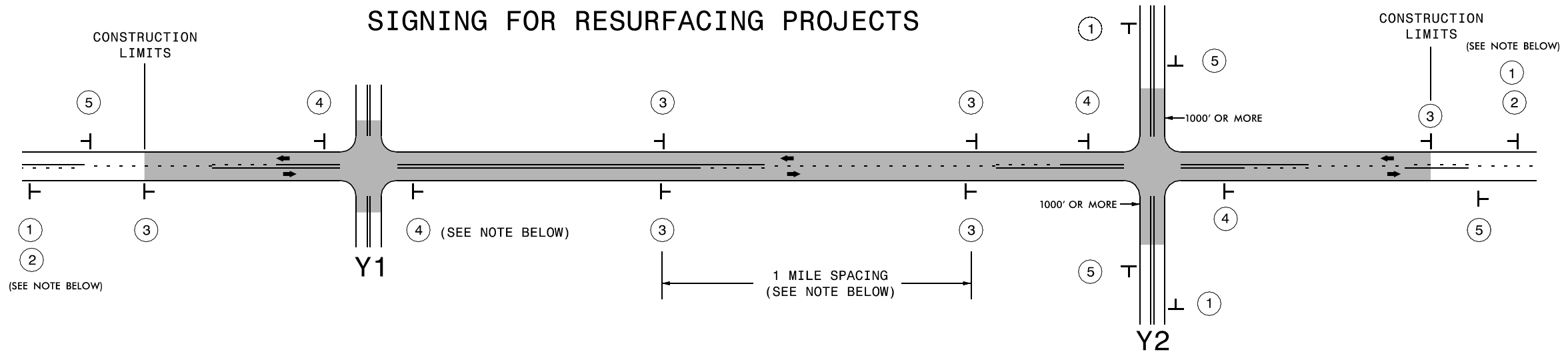

LEGEND	
⊥	STATIONARY SIGN
←	DIRECTION OF TRAFFIC FLOW

MAINLINE (-L-) SIGNING

-Y- LINE SIGNING

SIGNING NOTES AND PLACEMENT PER DIRECTION	MAINLINE (-L-) SIGNING		-Y- LINE SIGNING	
	①	 W20-1 48" X 48"	PLACE 1000' PRIOR TO BEGINNING OF CONSTRUCTION LIMITS. ONLY USED ON -Y- LINES IF RESURFACING LIMITS EXTEND 1000' ALONG -Y- LINE.	<p>NO REQUIRED STATIONARY SIGNING FOR THE FOLLOWING -Y- LINE CONDITIONS:</p> <ol style="list-style-type: none"> 1) LESS THAN 1000' OF RESURFACING ALONG -Y- LINE 2) SUBDIVISION ROADS 3) DEAD END ROADS <p>WHEN PAVING/CONSTRUCTION ACTIVITIES PROCEED ACROSS AN UNSIGNED -Y- LINE, ADVANCE WARNING PORTABLE SIGNS SHALL BE USED ALONG THE -Y- LINE AS SHOWN BELOW. REMOVE UPON COMPLETION OF WORK.</p> <div style="display: flex; justify-content: space-around;"> <div style="text-align: center;"> <p>W20-1 48" X 48"</p> </div> <div style="text-align: center;"> <p>W20-7 A 48" X 48"</p> </div> </div> <p>PLACED 500' IN ADVANCE OF FLAGGER. PLACED 250' IN ADVANCE OF FLAGGER.</p>
	②	 W7-3aP 24" X 18"	#2 SIGN ONLY USED WHEN RESURFACING LIMITS ARE 2 OR MORE MILES IN LENGTH. ROUND UP TO NEXT WHOLE NUMBER. (NO FRACTIONAL OR DECIMAL NUMBERS)	
	③	 SP 13107 48" X 48"	PLACE INITIALLY AT THE CONSTRUCTION LIMITS AND SPACED 1 MILE APART THEREAFTER. IF NO -Y- LINES EXIST, PLACE 2ND SET 1/2 MILE FROM THE CONSTRUCTION LIMITS AND THEN SPACE 1 MILE THEREAFTER.	
④	 SP 13106 48" X 48"	THESE ARE FOR -Y- LINES THAT ARE "THROUGH" ROADWAYS. DEAD END AND SUBDIVISION ROADS ARE NOT "THROUGH" ROADWAYS. INSTALL 500' +/- FROM EACH -Y- LINE APPROACH AS SHOWN ABOVE. FOR MULTIPLE -Y- LINES THAT ARE SEPARATED BY 0.25 MILES OR LESS, TREAT AS A SINGLE UNIT AND INSTALL WITHIN 500' OF EACH APPROACH. A MAXIMUM OF 2 SIGN SETS PER MILE. DO NOT INSTALL WHEN -Y- LINES ARE WITHIN 0.5 MILES FROM "END ROAD WORK" SIGN.		
⑤	 G20-2 A 48" X 24"	PLACE 500' FOLLOWING THE END OF CONSTRUCTION LIMITS.		

8/8/2013
 S:\T\U\WZTC\Resurfacing\2013\Documents\New_Pr ocedures_05_09_2013\Resurfacing_AdvWarn_2Ln.dgn
 User:frmgarr.ett

DIVISION OF HIGHWAYS
STATE OF NORTH CAROLINA
DEPARTMENT OF TRANSPORTATION
WORK ZONE TRAFFIC CONTROL

**RESURFACING
ADVANCE WARNING SIGNS
FOR
RURAL AND SUBURBAN
2 LANE ROADWAYS**